



### **NOTE**

TO AVOID LOSING PARTS OVER THE SIDE, WE SUGGEST YOU TIE A LIGHT LINE TO THE DAVIT, BASE SOCKET, AND RAIL CLAMP WHILE ASSEMBLING.

1. Fit rail clamp over top aft rail in chosen position with 1" stub facing aft.
2. Place nuts, washers, and locknut in the same order as supplied. Squeeze rail clamp down and carefully tighten locknut. Do not forget the small washer under the locknut. **Do not tighten too much as this may need readjusting.**
3. Hold Davit up in place with rail clamp and check if height is correct. **NOTE:** the rail clamp assembly can be adjusted up and down to aid in fitting.
4. Slip the davit leg into the base socket assembly, and use tape to temporarily retain the base socket assembly in place.
5. Fit the rail clamp assembly over the rail clamp stub. Push both parts together firmly and align the holes so that the quick release pin can be placed through the clamp assembly on the Davit and through the rail clamp stud. The stub may need rotating 180° to allow easy pin fitting. The set screw (Allen head) can also be tightened.
6. The set screw is only a temporary means of retaining the Davit in place while completing the alignment so **DO NOT** place any load on the Davit at this time. The light safety line can be a real help here!
7. Now tighten the rail clamp nuts.
8. Position the Davit leg and base socket and fasten the base plate to the deck, cap-rail or transom. **NOTE:** The base plate and socket should be rotated until they best suite the deck, cap-rail or transom angle. This may not be exactly fore and aft, but is important they are not forced down under tension as it will restrict easy turning of the Davit for folding and storage. If necessary, a small trimming pad of teak or plastic can be used to adjust this angle.
9. Align the Davit and drill a 1/4" hole through the small guide holes in the foot socket. Drill from both sides and then pass the bit through the align the holes. Pass the 1/4" bolt (supplied) through this hole to secure the Davit.



## **NOVA DAVIT**

### **NOTE**

The 1/4" retaining bolts and 2 set screws on the rail tee joints are only meant as a **LIGHT DUTY RESTRAINT** against lateral forces. **THE DINGHY SHOULD ALWAYS BE SECURELY RESTRAINED FROM ATHWART-SHIP MOVEMENT WITH LINES.** If you prefer to have your davits quick folding for storage or removable, the 1/4" bolt in the base socket can be replaced with a quick release fast pins (Forespar P/N 156445). The diagonal bracing struts, supplied with clamps, which clamp to the rail and davit arm should be fitted to secure the davits laterally. These struts brace the davits back to the rail and greatly increase the davits outer end stability.

### **WARNING**

**DO NOT LEAVE ENGINES ON DINGHIES HOISTED ON DAVITS. THIS WEIGHT OVERLOADS ONE ARM AND CAN LEAD TO FAILURE OF DAVIT ARM AND/OR STERN RAILS. REMOVE THE ENGINE BEFORE HOISTING DINGHY.**

**CONTINUE ON NEXT PAGE**

# FORESPAR®

## NOVA DAVIT

**INSTALL  
INFO**

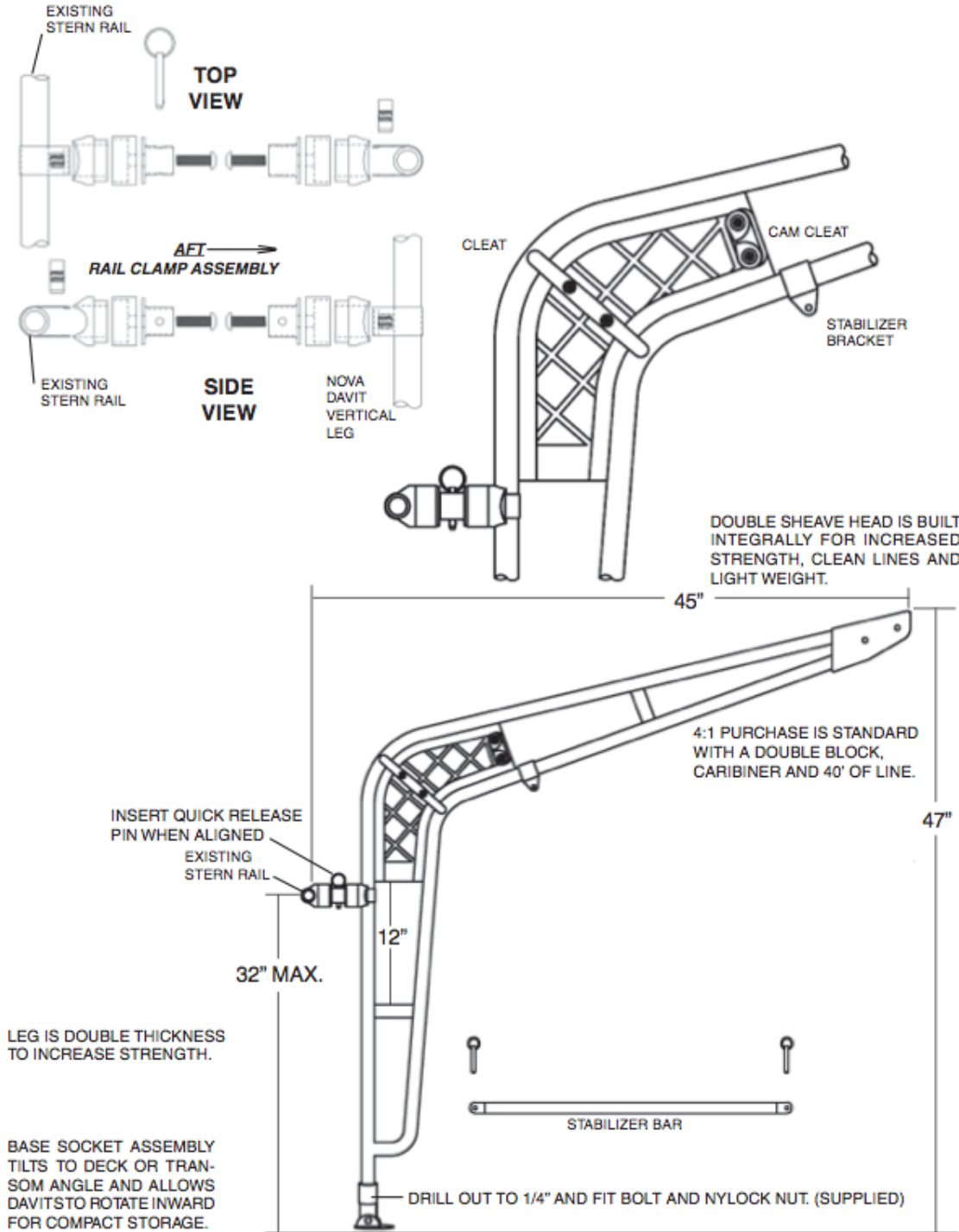

### Forespar®

22322 Gilberto Rancho Santa Margarita, CA. 92688

Ph: 949-858-8820 Fax: 949-858-0505

[www.forespar.com](http://www.forespar.com) [sales@forespar.com](mailto:sales@forespar.com)

[www.facebook.com/foresparsailing](http://www.facebook.com/foresparsailing) [www.twitter.com/foresparsailing](http://www.twitter.com/foresparsailing)